

## SPECIFICATION DATA SHEET

## PRODUCT DETAILS

Manufacturer :	Jaquar	Type:	Wall Hung-Bidet
Range :	Aria	Material:	Ceramic - Vitreous China
Colour:	White	BOM doc.NO.	JSW/01/2018/0029
Technical Details:	Tap hole dia. 35 $\phi$ +2 -1mm ID of waste outlet hole 45 $\phi$ +2 -3 mm		

## ARTICLE NAME: BIDET



## TECHNICAL DIMENSIONS

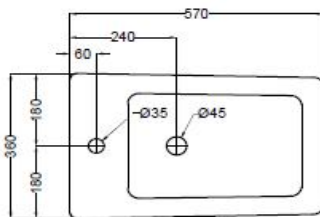

TOP VIEW

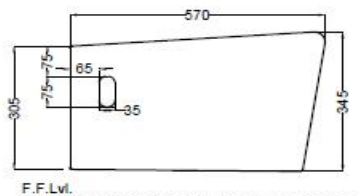

SIDE VIEW

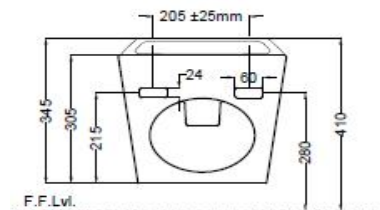

BACK VIEW

ALL DIMENSIONS ARE IN MM.  
(TOLERANCE  $\pm$  5 MM)

## PRODUCT DIMENSIONS

Length (mm)	Width (mm)	Height (mm)	Net weight (kg)	USP
360	570	345	24	With over flow hole and anti germ glaze

## ACCESSORIES PROVIDED

Overflow hole cap	ZPS-WHT-9012B
Side cap	ZPS-WHT-SCO1

## ACCESSORIES RECOMMENDED

Rag bolt	ZPS-MST-RB07
----------	--------------



## CARE AND CLEANING GUIDELINES

- ★ Vitreous china sanitary ware products are fragile in nature and need to be handled with care (to avoid personal injury) at all times during its storage, handling, installation and use thereafter.
- ★ The product is heavy and it is recommended that two persons hold it while it is being fixed.
- ★ Carefully inspect the new product for damage before installation.
- ★ Risk of product damage. Over tightening may cause breakage or chipping of vitreous china.
- ★ Risk of external leakage. Do not lift or rock the bowl after placement.
- ★ Always test your cleaning solution on an inconspicuous area on the product before applying it to the entire surface.
- ★ Do not allow cleaners to sit or soak on the product.
- ★ Use a soft, dampened sponge or cloth to clean. Never use abrasive material like a bristle brush or scouring pad.
- ★ Wipe surfaces clean and rinse completely with water immediately after applying cleaners.
- ★ Clean Chrome, stainless steel surfaces once a week. Do not use cleaners containing chloride on chrome, stainless steel. If used, rinse the surface immediately to prevent corrosion.
- ★ Wherever chrome plating is used on the products, use only warm water to clean and then dry with a soft cloth.

## CERTIFICATION

Compliance : Technical dimensions are in accordance and EN 997: 202+A1:MS 1522:2015/CE  
All technical dimensions are in accordance to British standards, Bureau of Indian Standards



## PACKAGING DETAIL

Length (mm)	Width (mm)	Height (mm)	Gross Weight(kg)	Length (mm)	Width (mm)	Height (mm)	no of pieces on pallet
610	370	370	25.5	1140	1140	2285	16



Prepared By Designer Date	Controlled By Quality control	Verified By Product Manager	Approved By Sanitaryware Head
Revision/Version	1	Plotter Updated on	Month

22-Aug Year 2019